

**ATTENTION:** All Bidders

**ADDENDUM #2**

**FOR**

**FRUITDALE ROAD AND MCGARIGLE ROAD IMPROVEMENTS AND SR 9  
PEDESTRIAN/BICYCLE SAFETY IMPROVEMENTS PROJECT**

*City of Sedro-Woolley Project No. 2009-PW-02  
Federal Aid Project Nos. ARRA-HPP-7390(001)  
& ARRA-STPE-0009(057)  
WSDOT Contract Nos. TA-3543 & TA-3340*

**April 28, 2009**

**The following revisions, additions, and clarifications to the project Proposal, Plans, and Special Provisions are provided for this project:**

**INSTRUCTIONS AND PROPOSAL**

1. There are no revisions to the proposal by this addendum.

**PLANS**

1. Plan Sheet C2.8:

References to PVC in storm pipe label for pipe east of CB F4 is DELETED and REPLACED with SD to match other plan sheets.

2. Plan Sheet C2.12:

At STA 108+10 LT, a concrete inlet is ADDED with 35 LF 12" CPSSP at a slope of 0.005 ft/ft across SR 9 to connect to an existing catch basin. Refer to Addendum #2 sketch SK-NO.9. These quantities associated with this additional work were added to the revised Bid Schedules issued with Addendum #1.

3. Plan Sheet C6.1 to C6.5:

Replacement plan sheets for C6.1, C6.2 and C6.3 are issued with this addendum. Revisions include the replacement of signs to conform with the current MUTCD standards and the replacement of some wood posts with steel posts.

No replacement sheets for C6.4 and C6.5 will be issued (see notes below).

On plan sheet C6.4: REPLACE the "Dead End" sign (W14-1, 24"x24") at Dana Drive.

**ADDENDUM NO. 2  
4/28/2009**

FRUITDALE ROAD AND MCGARIGLE ROAD IMPROVEMENTS PROJECT  
AND SR 9 PEDESTRIAN/BICYCLE SAFETY IMPROVEMENTS PROJECT

On plan sheet C6.5: REPLACE the “Dead End” sign (W14-1, 24”x24”) at Orth Way, REPLACE the “Stop Signs” (R1-1, 30”x30”) at Cultus Mtn drive and Lucas Drive. REPLACE the Speed Limit sign (R2-1 24”x30”) at STA 125+22 LT.

Also added are the locations for the installation of the solar powered school zone beacons, speed readers and end school zone signs. These were added with Addendum #1.

## **SPECIAL PROVISIONS**

1. Sections 7-30, Storm Water Pump Station and 7-31, Sanitary Sewer Pump Station, Materials Sections, are supplemented with the following:

C900 PVC pipe for the storm water and sanitary sewer forcemains shall be Class 150.

2. Section 7-31, Sanitary Sewer Pump Station, Section 7-31.2(1) Pump Station, Pumps (SP-110), is supplemented with the following:

To the end of the first sentence of the first paragraph ADD: ...or engineer approved equal.

3. Section 7-31, Sanitary Sewer Pump Station, Section 7-31.3(4), Pump Station Building, is supplemented with the following:

Work related to the building shall also include the installation of motor actuated louver systems and insulated roof penetration for the generator exhaust system.

The louver systems will be installed in the north and south walls of the building. Wall framing shall include the necessary headers. Installation shall also include furnishing and installing all necessary electrical components to provide power to the louver actuators and switches. Actuators are to be wired such that the louvers will open when the generator starts up. The Contractor shall also furnish and install a flexible sheet metal duct transition from the generator motor radiator to the intake louver.

Louvers: Greenheck combination louver/damper Model EAC-401 with bird screens, 48”W x 54”H (intake) and 48”Wx45”H (discharge), or approved equal.

The Contractor shall furnish and install the components and framing necessary to route the 3-inch exhaust system from the generator motor vertically through the roof. Including Hapco (or approved equal) roof thimble and flashing (42” length approximate, the Contractor shall verify the correct length when the exact location of the penetration is finalized), exhaust weather shield, and heavy duty rain cap.

4. Section 7-31, Sanitary Sewer Pump Station, Section 7-31.5, Payment, is supplemented with the following:

The payment description for “Pump Station Building” is supplemented with the following:

Costs associated with the complete installation of the intake and discharge louver systems and exhaust extension through the roof (all per the manufacturers recommendations and applicable codes) shall be included in the lump sum price for the Pump Station Building.

### **ADDENDUM NO. 2 4/28/2009**

FRUITDALE ROAD AND MCGARIGLE ROAD IMPROVEMENTS PROJECT  
AND SR 9 PEDESTRIAN/BICYCLE SAFETY IMPROVEMENTS PROJECT

5. Section 8-21, Permanent Signing, Section 8-21.1, Description, is supplemented with the following:

Work shall also include replacing or removing noted signs and posts, including the street name signs. Replacement signs shall be of the type and size indicated.

6. Section 8-21, Permanent Signing, Section 8-21.2, Materials, is supplemented with the following:

Sheeting for all signs noted to be replaced shall be 3M High Intensity Prismatic sheeting or approved equal.

Posts shall be round galvanized steel, 10'-6" long, 2-3/8" O.D. and wall thickness of 0.095" and have galvanized post caps or mounting brackets for street name signs where applicable.

All mounting hardware shall be galvanized.

Post anchoring system shall be V-Loc, 30" with wedge.

7. Section 8-21, Permanent Signing, Section 8-21.5, Payment, is supplemented with the following:

The lump sum price shall also include providing and installing new signs and posts where noted in the Plans, and providing and installing replacement signs and posts where noted in the Plans including all mounting hardware and post anchoring system.

8. Appendix C, Fruitdale Road Sewer Pump Station Electrical Specifications and Details, is supplemented with the following:

A drawing showing the various panel positions inside the pump station building is provided.

**OTHER INFORMATION:**

1. This Addendum will be incorporated in the contract when awarded and when formally executed.

**Attachments:**

Replacement Plan Sheets C6.1, C6.2 and C6.3.  
ADDMM#2 Sketch SK-NO.9.  
Appendix C: INTERIOR PANEL LAYOUT

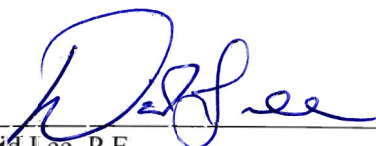
  
\_\_\_\_\_  
David Lee, P.E.  
Project Engineer

**ADDENDUM NO. 2**  
**4/28/2009**

FRUITDALE ROAD AND MCGARIGLE ROAD IMPROVEMENTS PROJECT  
AND SR 9 PEDESTRIAN/BICYCLE SAFETY IMPROVEMENTS PROJECT

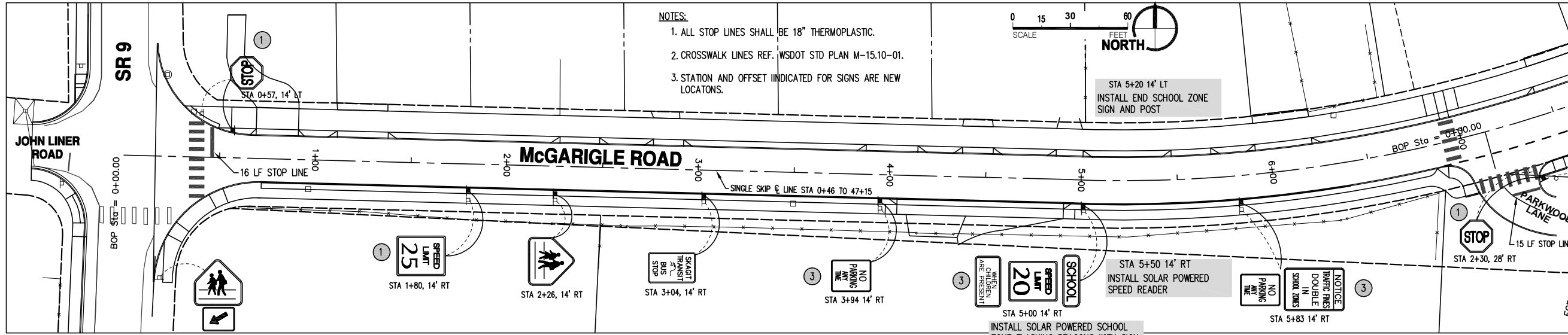

**NOTES:**  
 1. ALL STOP LINES SHALL BE 18" THERMOPLASTIC.  
 2. CROSSWALK LINES REF. WSDOT STD PLAN M-15.10-01.  
 3. STATION AND OFFSET INDICATED FOR SIGNS ARE NEW LOCATIONS.

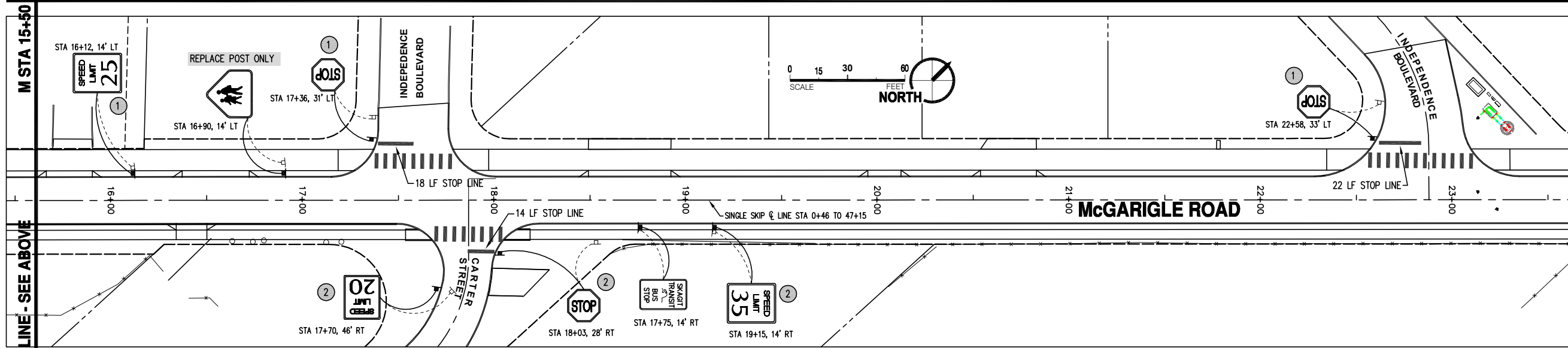
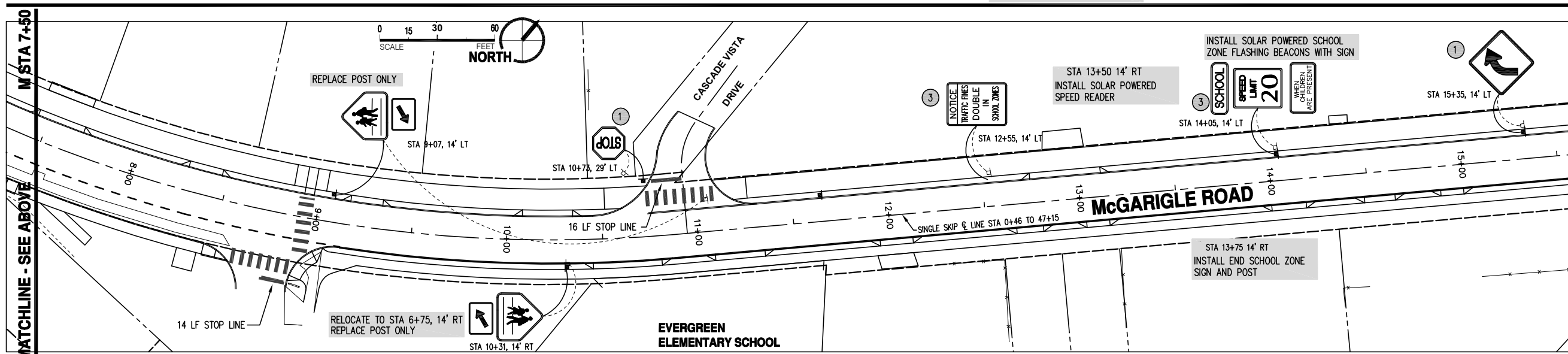
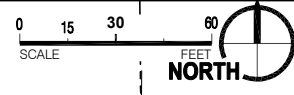

**SIGN NOTES:**  
 ① REPLACE SIGN  
 ② REPLACE SIGN AND POST  
 ③ REMOVE SIGN AND POST

ALL SIGNS SHALL BE MUTCD STANDARD SIZE UNLESS SPECIFICALLY NOTED OTHERWISE.

MATCHLINE - SEE BELOW M STA 7+ M STA 15+50 MATCHLINE - SEE BELOW M STA 23+50 MATCHLINE - SEE SHEET C6.2

DATE	REVISIONS	BY
4-27-09	ADDENDUM #2 REPLACEMENT SHEET	DEL

**FRUITDALE ROAD AND MCGARIGLE ROAD IMPROVEMENTS PROJECT**  
 LOCATED NEAR SEDRO WOOLLEY WASHINGTON  
 SEC. 18, TWN. 35 N.; RGE. 5 E W.M.

**CITY OF SEDRO-WOOLLEY**  
 CONTACT: MARK FREIBERGER, P.E.  
 325 METCALF STREET  
 SEDRO-WOOLLEY, WA 98284  
 PH: 360-855-0771 FAX: 360-855-0733

**Leonard, Boudnot, & Skodje Inc.**  
 PROFESSIONAL ENGINEERS & LAND SURVEYORS  
 805 South First Street, P.O. Box 1228  
 Mount Vernon, WA 98273  
 Tel: 360-336-5751 Fax: 360-336-3961

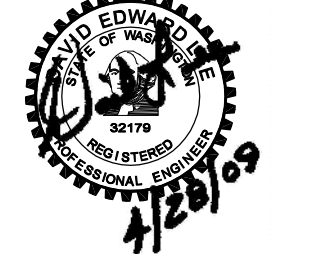

C.R.P. NO. ES 91110-02  
 FED. AID NO. HPP-7390(001)  
 DESIGNED BY: DEL  
 DRAWN BY: RAH  
 CHECKED BY: DEL  
 APPROVED BY: DEL  
 PLOTTED: 4/28/09 2:37 PM  
 LAST EDIT: 4/27/09 9:42 AM  
 FILE: J:\2007\07002\Eng\PLAN  
 SHEETS\07002\CHAN.dwg

**MCGARIGLE ROAD CHANNELIZATION, SIGNAGE & STREET LIGHT PLAN STA 0+00 TO STA 23+50**

SHEET **C6.1**

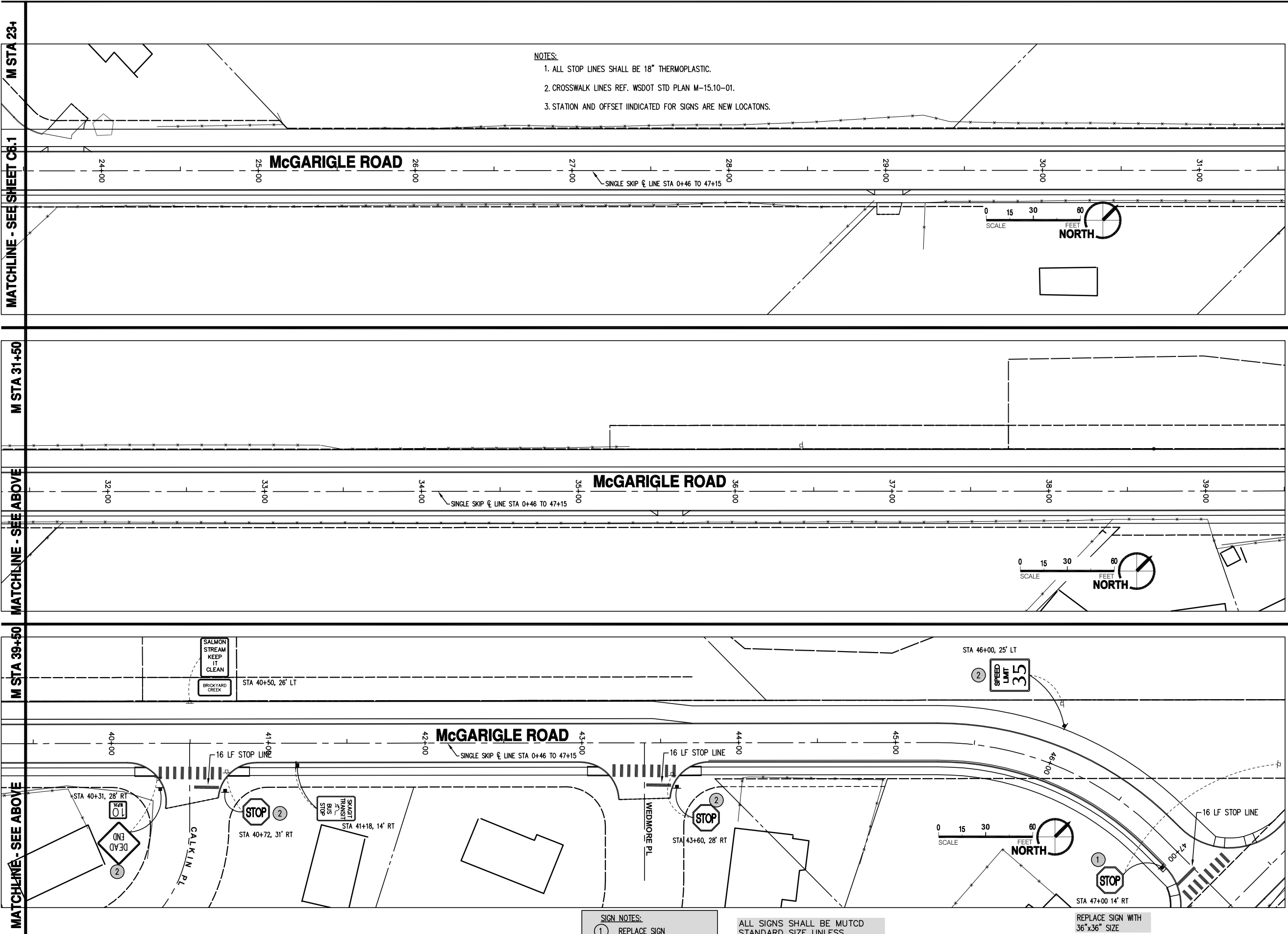

NOTES:  
 1. ALL STOP LINES SHALL BE 18" THERMOPLASTIC.  
 2. CROSSWALK LINES REF. WSDOT STD PLAN M-15.10-01.  
 3. STATION AND OFFSET INDICATED FOR SIGNS ARE NEW LOCATIONS.

SIGN NOTES:  
 ① REPLACE SIGN  
 ② REPLACE SIGN AND POST  
 ③ REMOVE SIGN AND POST

ALL SIGNS SHALL BE MUTCD STANDARD SIZE UNLESS SPECIFICALLY NOTED OTHERWISE.

REPLACE SIGN WITH 36"x36" SIZE

M STA 23+ MATCHLINE - SEE SHEET C6.1  
 M STA 31+50 MATCHLINE - SEE ABOVE  
 M STA 39+50 MATCHLINE - SEE ABOVE  
 M STA 47+00 MATCHLINE - SEE BELOW  
 M STA 38+50 MATCHLINE - SEE BELOW  
 M STA 31+ MATCHLINE - SEE BELOW

DATE	REVISIONS	BY
4-27-09	ADDENDUM #2 REPLACEMENT SHEET	DEL

**FRUITDALE ROAD AND MCGARIGLE ROAD IMPROVEMENTS PROJECT**  
 LOCATED NEAR SEDRO WOOLLEY WASHINGTON  
 SEC. 18, TWN. 35 N.; RGE. 5 E W.M.

**CITY OF SEDRO-WOOLLEY**  
 CONTACT: MARK FREIBERGER, P.E.  
 325 METCALF STREET  
 SEDRO-WOOLLEY, WA 98284  
 PH: 360-855-0771 FAX: 360-855-0733

**Leonard, Boudnot, & Skodje Inc.**  
 PROFESSIONAL ENGINEERS & LAND SURVEYORS  
 905 South First Street, P.O. Box 1228  
 Mount Vernon, WA 98273  
 Tel: 360-336-5751 Fax: 360-336-3991

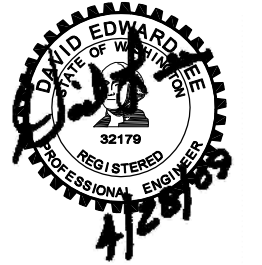

C.R.P. NO. ES 91110-02  
 FED. AID NO. HPP-7390(001)  
 DESIGNED BY: DEL  
 DRAWN BY: RAH  
 CHECKED BY: DEL  
 APPROVED BY: DEL  
 PLOTTED: 4/28/09 2:38 PM  
 LAST EDIT: 4/27/09 9:42 AM  
 FILE: J:\2007\07002\Eng\PLAN  
 SHEETS\07002\CHAN.dwg

**MCGARIGLE ROAD CHANNELIZATION, SIGNAGE & STREET LIGHT PLAN**  
 STA 23+50 TO STA 47+00

SHEET C6.2

F STA 32+00  
MATCHLINE - SEE SHEET BELOW

F STA 24+00  
MATCHLINE - SEE SHEET BELOW

SR 20  
ESTA 16+08  
BOP STA = 16+08.08

MATCHLINE - SEE SHEET C6.2 M STA 47+00

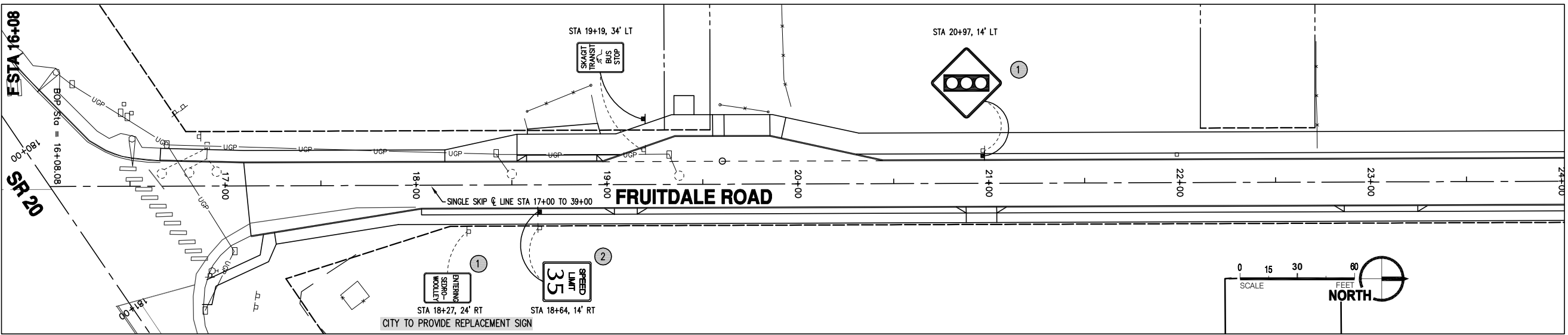
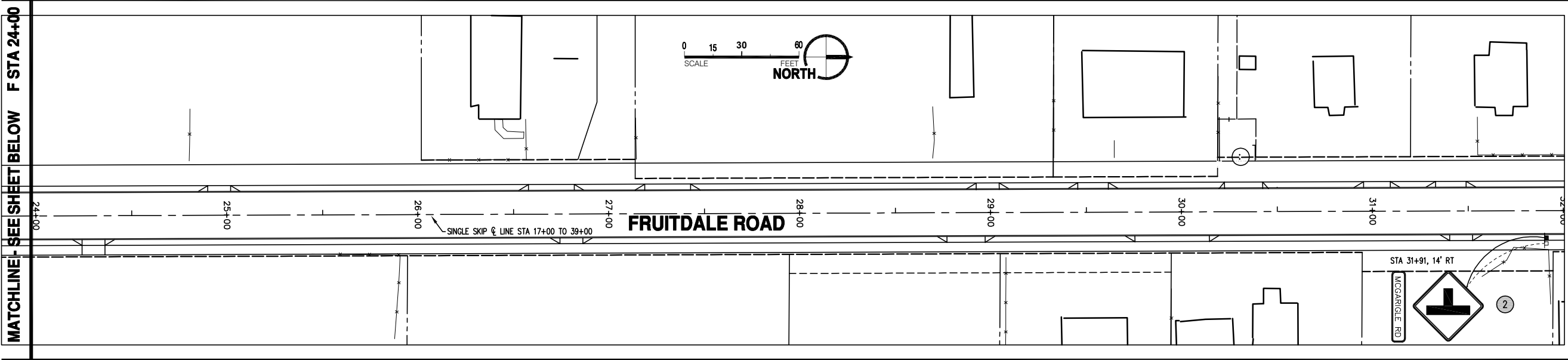
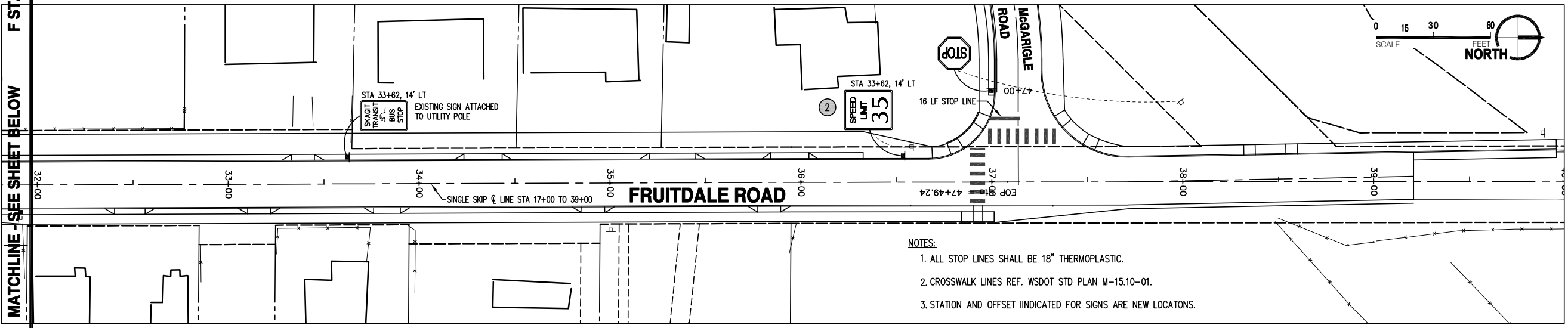

- NOTES:
1. ALL STOP LINES SHALL BE 18" THERMOPLASTIC.
  2. CROSSWALK LINES REF. WSDOT STD PLAN M-15.10-01.
  3. STATION AND OFFSET INDICATED FOR SIGNS ARE NEW LOCATIONS.

- SIGN NOTES:
- 1 REPLACE SIGN
  - 2 RPEPLACE SIGN AND POST
  - 3 REMOVE SIGN AND POST

ALL SIGNS SHALL BE MUTCD STANDARD SIZE UNLESS SPECIFICALLY NOTED OTHERWISE.

MATCHLINE - SEE ABOVE

DATE	REVISIONS	BY
4-27-09	ADDENDUM #2 REPLACEMENT SHEET	DEL

**FRUITDALE ROAD AND MCGARIGLE ROAD IMPROVEMENTS PROJECT**

LOCATED NEAR  
SEDRO WOOLLEY  
WASHINGTON  
SEC. 18, TWN. 35 N.; RGE. 5 E W.M.

**CITY OF SEDRO-WOOLLEY**  
SEAL: SEDRO-WOOLLEY, WASHINGTON

CONTACT:  
MARK FREIBERGER, P.E.  
325 METCALF STREET  
SEDRO-WOOLLEY, WA 98284  
PH: 360-855-0771 FAX: 360-855-0733

**Leonard, Boudnot, & Skodje Inc.**

PROFESSIONAL ENGINEERS & LAND SURVEYORS

905 South First Street, P.O. Box 1228  
Mount Vernon, WA 98273  
Tel: 360-336-5751 Fax: 360-336-3961

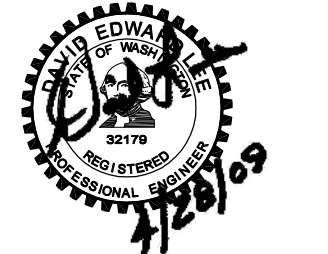

C.R.P. NO. ES 91110-02  
FED. AID NO. HPP-7390(001)  
DESIGNED BY: DEL  
DRAWN BY: RAH  
CHECKED BY: DEL  
APPROVED BY: DEL  
PLOTTED: 4/28/09 2:39 PM  
LAST EDIT: 4/27/09 9:42 AM  
FILE: J:\2007\07002\Eng\PLAN  
SHEETS\07002\CHAN.dwg

**MCGARIGLE ROAD CHANNELIZATION, SIGNAGE & STREET LIGHT PLAN**  
STA 39+00 TO STA 17+00

SHEET  
**C6.3**

STA 108+10, 17.2' LT  
 INSTALL CONC. INLET  
 BI-DIRECTIONAL VANED GRATE  
 TOP = 61.98  
 IE 12" CPSSP OUT E = 57.98

INSTALL 35 LF 12" CPSSP  
 SLOPE = 0.005 FT/FT TO  
 EXISTING CB

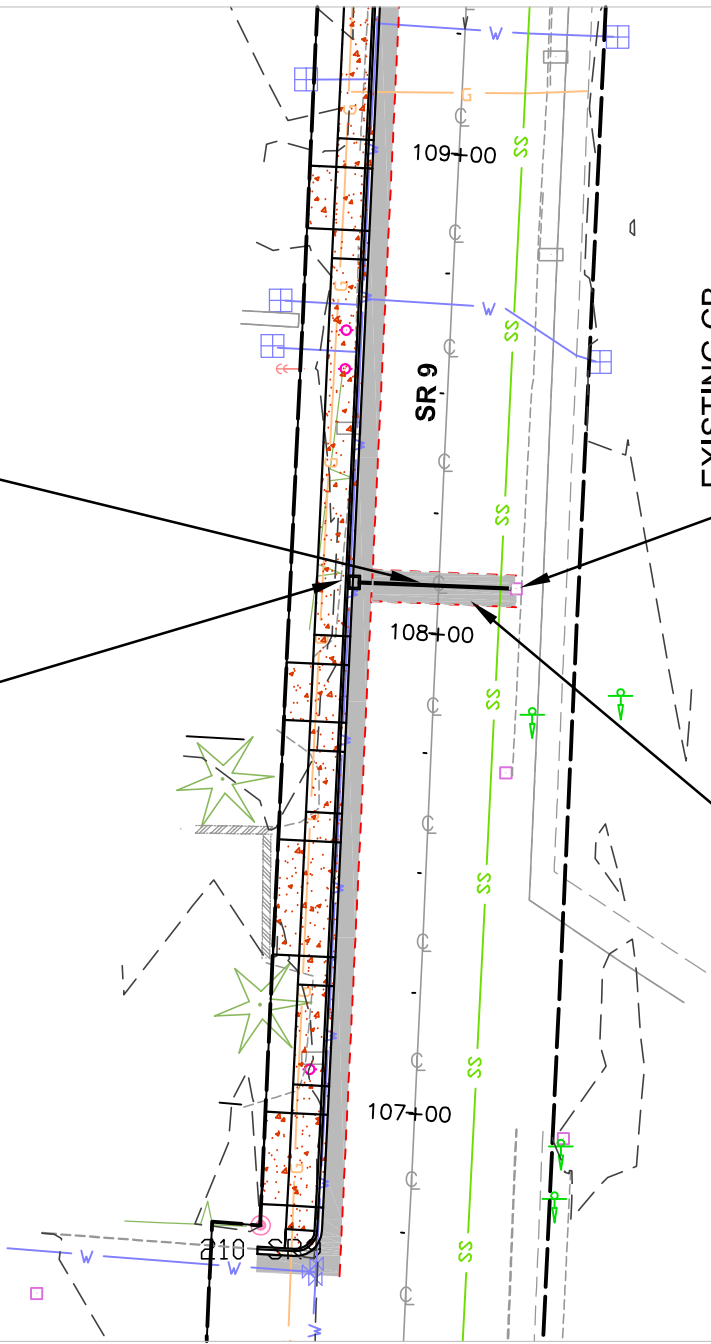

EXISTING CB  
 IE 12" CPSSP IN W = 57.80

TRENCH REPAIR PER  
 PLAN DETAILS.  
 MATCH EXISTING ASPHALT  
 THICKNESS (6" MIN.)

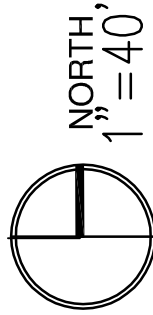

FRUITDALE ROAD AND MCGARIGLE ROAD  
 IMPROVEMENTS PROJECT AND SR 9  
 PEDESTRIAN/BICYCLE SAFETY IMPROVEMENTS  
 PROJECT

City of Sedro-Woolley

ADDENDUM-NO.2

Date	4-27-09	Project No.	07002
Sheet Ref.	C2.12	Scale	1"=40'

SK-NO.9

FILE-NAME

